

CAUTION: Do not remove the old window or wood sash until you verify that the dimensions of the new replacement window unit are correct.

Preparation of the Opening

1. Remove the old sashes by removing the interior and/or parting stops, metal jamb liners, sash counterweights, etc. on the sides and top of the opening, being careful not to damage the structure. Do not remove the exterior stop. Remove old sash counterweights if possible and insulate the counterweight pocket with fiberglass batt insulation.
2. Clean and remove any peeling paint or debris from the window opening, especially on the inside of the exterior stop.
3. Make sure the opening is level and plumb and that the side jamb material will accept fastening screws solidly. If not, repair as needed.

Older window designs vary considerably so these steps should be considered a guideline for the installer with the intent of creating an opening that will allow the replacement window frame to be installed as shown from the inside against the exterior stops of the old window.

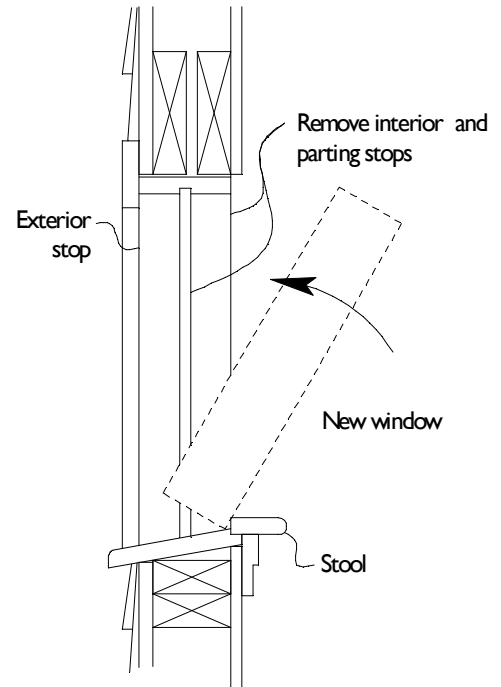

Installation of the New Window

1. Dry fit the window unit into the opening by placing the sill of the window over the existing interior sill and tipping the window unit into the opening as shown above. You should have 1/8" to 1/4" between the opening and the new window frame. Remove the window unit from the opening and remove the balance covers and sash stops from the window (hung windows only) to expose the installation holes in the jambs. Use a small flat blade screwdriver to pop these parts out of the frame, taking care not to damage them.
2. Run a continuous bead of good quality silicone caulking on the inside of the exterior stops on the sides and top of the opening; also run a bead on the outside of the wood stool of the old window.
3. Now, place the window back into the opening making certain it is centered side to side in the rough opening.
4. Install shims as needed between new windowsill and the existing wood sill and check it for level.
5. Install shims as needed behind the installation holes in the jambs, making sure the frame is plumb, level and square as you go. The window is square when the two diagonal measurements are equal.

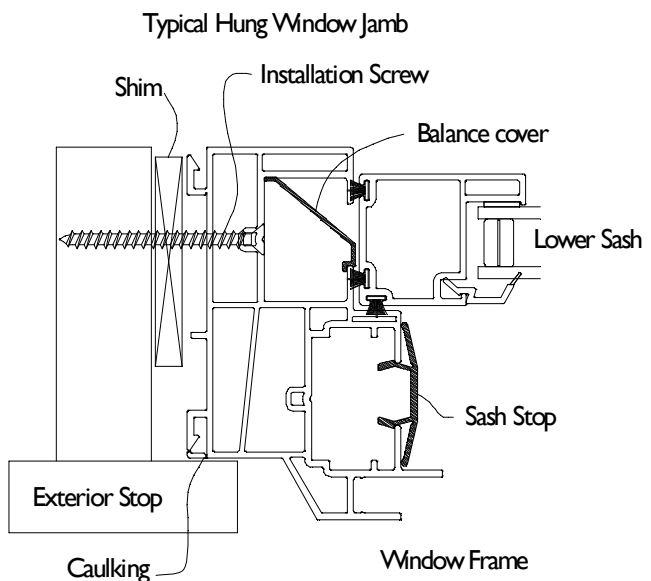

6. The replacement windows are held in place by stainless steel screws (provided) which fasten the side jambs of the new window to the existing wooden jamb of the old window frame. (Note: expose the mounting holes by opening the window or raising and lowering the sashes.) When fastening the screws, make sure to press the window unit against the outside stops to ensure a tight fit. Screws must be installed flush to the vinyl jambs without overtightening for proper clearance of the balance mechanism.
7. Install the top and bottom screws on both sides of the window frame. Adjust the alignment screws at the center of the window jambs for straightness of the jambs using shims behind the screw pads as needed.
8. Install the center installation screws.
9. Using fiberglass batt insulation material fill the cavity between the side jambs and head of the window and the rough opening being careful not to overstuff this pocket.

Installation of the Sill Adapters

Sill adapters enclose the cavity between the bottom of the replacement window and the sloped wooden sill of the old window frame. The adapter snaps into the exposed accessory groove at the bottom exterior of the window.

1. Fill the cavity under the replacement window using fiberglass batt insulation.
2. Cut the sill adapter to length. You may prefer to cut it a little long and tuck the ends behind the exterior stops.
3. Measure the height from the wood sill to the groove in the bottom of the replacement window.
4. Mark the sill adapter and score with a utility knife using the grooves provided on the back of the adapter. Snap off the excess material and discard.
5. Now snap the sill adapter into the accessory groove on the window.
6. Neatly run a bead of caulking where the sill adapter meets the wood sill and up the two edges at the blind stops. Tool this caulking for a neat appearance.

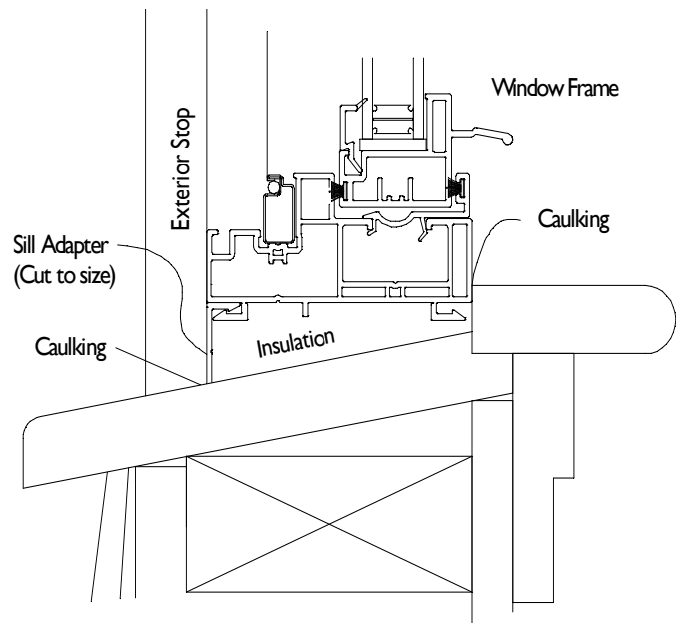

The **optional two-piece sill adapter** installs similarly but the height is adjustable so no trimming is necessary. Snap the assembly into the accessory groove as above, apply a bead of caulking under the adapter, and pull down the bottom portion of the two-piece adapter so it sets in the caulking on the wooden sill of the old window. Tool any exposed caulking for a neat appearance.

An **optional head expander** is available to help fit the replacement window unit into the rough opening, especially when the opening is out of square. The head expander fits over the top of the window unit and can be adjusted up or down at any angle to fit the opening.

Finish-up and Adjustment

Check the operation of the window and make final adjustments as necessary. Pay close attention that the window jambs are not bowed as this will make operation difficult and diminish performance. Reinstall interior trim along the top and sides of the window frame. Demonstrate the operation of the window to the homeowner including tilt/wash features.

Thank you for choosing Paradigm Window Solutions. Call 1-877-9WINDOW with any questions.